



Moore house, 2, Gatliff Road London, SW1W 8DT

£5,499 PCM

- Bright and spacious three-bedroom, two-bathroom apartment
- Modern Miele kitchen with integrated appliances and wine cooler
- Residents enjoy 24-hour concierge and fully equipped gym
- Offered furnished, available for immediate occupation
- Located in the prestigious Grosvenor Waterside development near Chelsea Bridge
- Comfort cooling / air conditioning throughout
- Beautiful communal gardens, on-site Sainsbury's Local and coffee shop
- Elegant open-plan reception room with access to a large enclosed balcony
- Luxury en-suite bathroom to principal bedroom
- Moments from Battersea Park, Sloane Square and Victoria Station

Moore House, 2 Gatliff Road, London SW1W 8DT

Second Floor
GROSS INTERNAL FLOOR AREA
APPROX. 105.5 SQ M / 1136 SQ FT

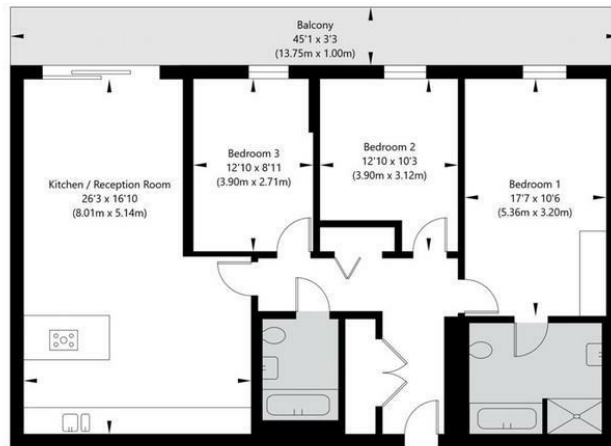

APPROXIMATE GROSS INTERNAL FLOOR AREA 105.5 SQ M / 1136 SQ FT

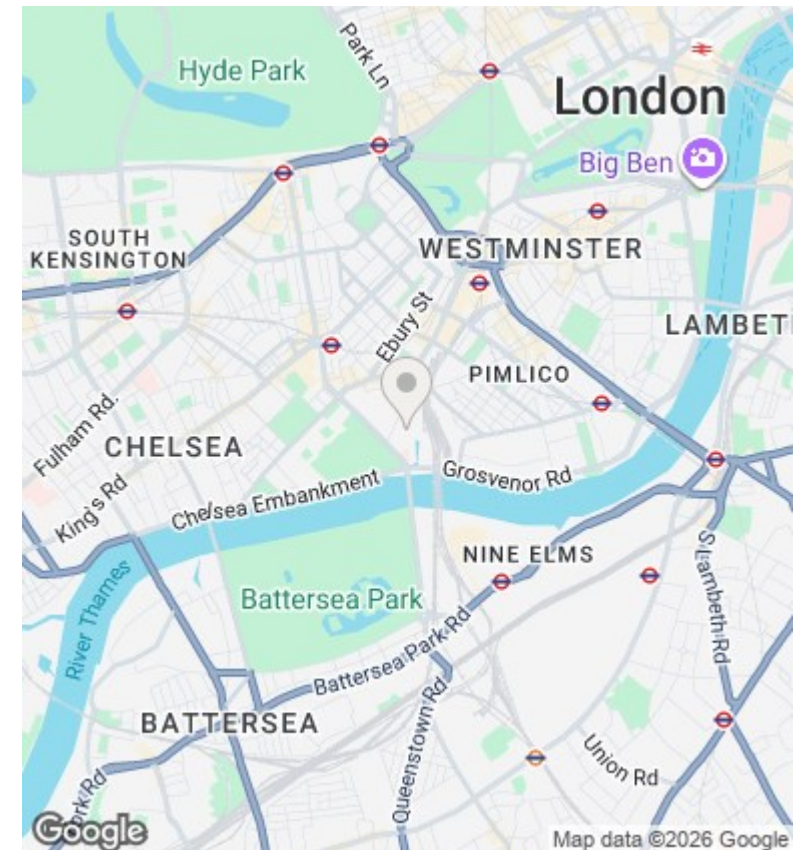

Viewings

Viewings by arrangement only.
Call 02077225022 to make an appointment.

Council Tax Band

G

EPC Rating:

B

Energy Efficiency Rating		
	Current	Potential
Very energy efficient - lower running costs		
(92 plus) A		
(81-91) B	84	84
(69-80) C		
(55-68) D		
(39-54) E		
(21-38) F		
(1-20) G		
Not energy efficient - higher running costs		
England & Wales	EU Directive 2002/91/EC	